

AVET REELS HX5.2-M.C. RAPTOR

HX5.2-M.C. RAPTOR
HXJ5.2-M.C. RAPTOR
HXW5.2 RAPTOR

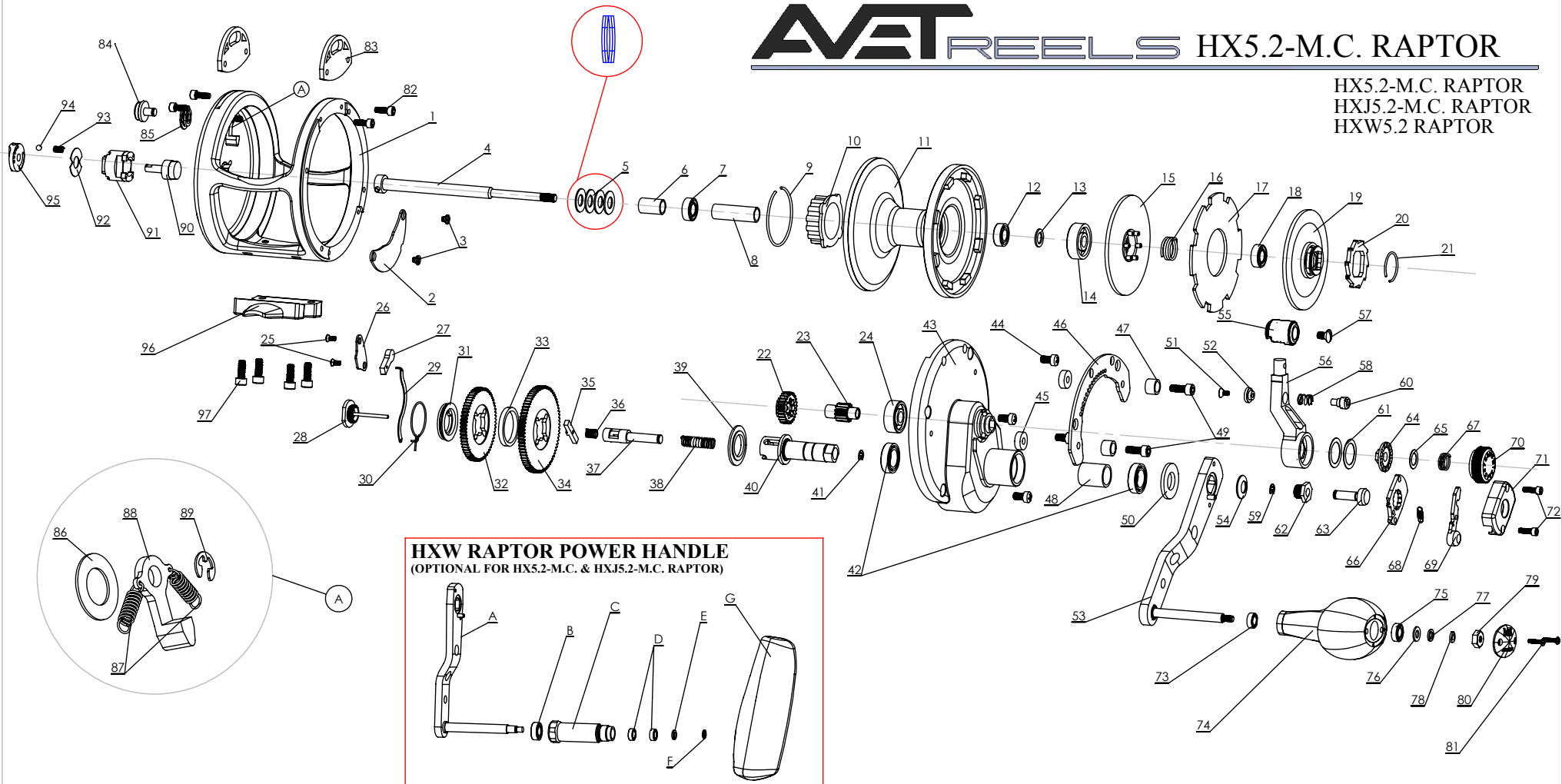

HXW RAPTOR POWER HANDLE (OPTIONAL FOR HX5.2-M.C. & HXJ5.2-M.C. RAPTOR)

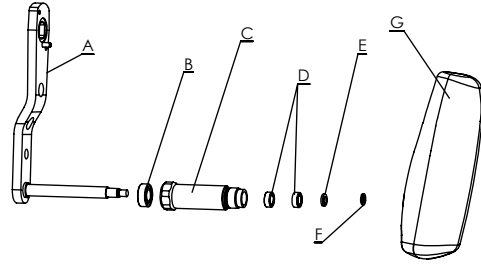

- | | | | | | |
|---------------------------------|------------------------------|----------------------------------|----------------------------|--------------------------------|------------------------------|
| 01 - Main House | 19 - Outer Brake Disk | 37 - Pusher | 55 - Lever Arm Head | 73 - Handle Shaft Bearing | 91 - MC Housing |
| 02 - Gear Cover | 20 - Antireverse Gear | 38 - Drive Shaft Spring | 56 - Lever Arm | 74 - Handle Knob | 92 - MC Washer |
| 03 - Cover Screw(2req.) | 21 - Disk Ring | 39 - Washer RT | 57 - Head Screw | 75 - Handle Knob Bearing | 93 - MC Spring |
| 04 - Spool Shaft | 22 - Large Pinion Gear | 40 - Drive Shaft | 58 - Spring | 76 - Washer | 94 - MC Ball |
| 05 - Belleville Washers(4 req.) | 23 - Small Pinion Gear | 41 - Drive Shaft E-clip | 59 - Push Knob E-clip | 77 - Lock Washer | 95 - MC Knob |
| 06 - Pusher Bushing | 24 - Drive Shaft Bearing | 42 - Drive Shaft Bearing(2 req.) | 60 - Strike Bypass Button | 78 - Spring Washer | 96 - Rod Mount |
| 07 - Spool Bearing.) | 25 - Dog Cover Screw(2 req.) | 43 - End Housing | 61 - Teflon Washer(2 req.) | 79 - Nut | 97 - Rod Mount Screw(2 req.) |
| 08 - Spool Bush | 26 - Dog Cover | 44 - End Housing Screws(4 req.) | 62 - Crank Arm Nut | 80 - Handle Cap | |
| 09 - Knob Retainer Ring | 27 - Dog | 45 - Spacer(2 req.) | 63 - Push Knob | 81 - Handle Cap Screw(2 req.) | HXW POWER HANDLE |
| 10 - Knob | 28 - Drive Shaft Stop Nut | 46 - Slide Plate | 64 - Drive Washer | 82 - Harness Log Screw(4 req.) | A - Crank Arm |
| 11 - Spool | 29 - Connection Arm | 47 - Lever Arm Stopper(2 req.) | 65 - Preset Knob Washer | 83 - Harness Log(2 req.) | B - Handle Washer |
| 12 - Spool Bearing | 30 - Friction Ring | 48 - Drive Shaft Bush | 66 - Lock Plate | 84 - Clicker | C - Handle Bush |
| 13 - Spool Spring Washer | 31 - Washer LF | 49 - Plate Screws(2 req.) | 67 - Preset Knob Spring | 85 - Clicker Housing | D - Handle Bearing |
| 14 - Inner Bearing | 32 - Drive Shaft Small Gear | 50 - Drive Shaft Washer | 68 - Release Arm Spring | 86 - Clicker Washer | E - Spring Washer |
| 15 - Inner Brake | 33 - Washer MLD | 51 - Lever Screw | 69 - Release Arm | 87 - Clicker Spring | F - Lock Washer |
| 16 - Spring | 34 - Drive Shaft Big Gear | 52 - Lever Bush | 70 - Preset Knob | 88 - Clicker Arm | G - Handle |
| 17 - Brake Pad | 35 - Fork | 53 - Crank Arm | 71 - Push Knob Cover | 89 - E-clip | |
| 18 - Outer Bearing | 36 - Fork Spring | 54 - Crank Arm Washer | 72 - Cover Screw(2 req.) | 90 - MC Shaft | |